

CHANNEL CONNECT is distinguished by its ability to magnetically connect to both ferrous and non-ferrous surfaces allowing for rapid installation and effortless repositioning. All mounting accessories are concealed within the channel itself, providing for a clean, uncluttered look.

PHYSICAL

Description	Surface mount channel with flat lens. Mounts to ferrous and non-ferrous surfaces using magnets with no visible fasteners once mounted.
Material	vv Aluminum
Lens Cover	Polycarbonate
Width	A: 0.76" (19.43mm)
Inner Width	B: 0.55" (14.09mm)
Height	C: 0.84" (21.43mm)
Length	2 meters

DIMENSIONS

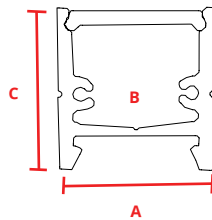

FINISH

Satin Silver	Red Powder Coat*
Deep Bronze Anodized*	Gray Powder Coat*
Matte Black Anodized*	Chrome*
White Powder Coat*	Custom RAL Powder Coat*
Blue Powder Coat*	

*Special order finishes may increase order lead time and incur an added cost

ACCESSORIES

	PART #
Anodized Aluminum Endcap	CHC-S-1921-EC
Anodized Aluminum End Cap w/hole	CHC-S-1921-ECH
Milky Lens	CHC-S-1921-CM
Channel Mounted Magnet	CHC-S-1921-MA
Wall Mounted Magnet	CHC-S-1921-M
1' Mounting Plate	CHC-S-1921-B1

*Heating magnet past 80°C will cause irreversible loss of magnetism.

COMPATIBLE FLEX PRODUCTS

	Not Blended	Blended w/Milky Lens
FLEX DC 15		FLEX DC 22 <i>Fits IP40 only</i>
FLEX DC 30		FLEX DC 44 <i>Fits IP40 only</i>
FLEX STP 73		FLEX STP RGBW
FLEX STP VARIABLE WHITE		FLEX DC VARIABLE WHITE <i>Fits IP40 only</i>
FLEX STP 40		FLEX STP 20

PART NUMBER BUILDER

SERIES	CHANNEL TYPE	DIMENSIONS	LENS	MOUNTING	FINISH
CHC = Channel Connect	S = Surface Mount	1921 = H 21mm x W 19mm	2M = Milky Lens	FS = Ferrous Surface NFS = Non-Ferrous Surface	SL = Satin Silver *MB = Matte Black Anodized *BZ = Deep Bronze Anodized *WH = White Powder Coat *GY = Gray Powder Coat *BL = Blue Powder Coat *RD = Red Powder Coat *YL = Yellow Powder Coat *CH = Chrome *CR = Custom RAL Powder Coat

ACCESSORIES

CHC-S-1921-EC

Anodized Aluminum End Cap

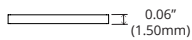
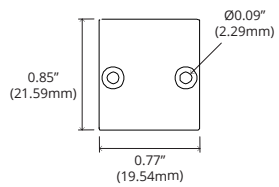
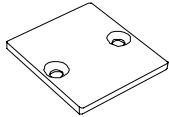

CHC-S-1921-ECH

Anodized Aluminum End Cap w/Hole

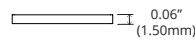
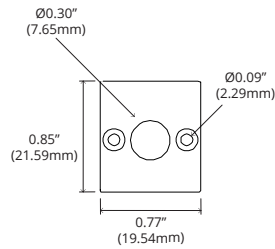
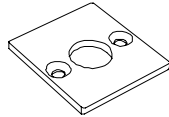

CHC-S-1921-CM

Milky Lens

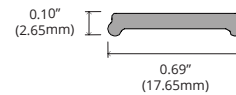
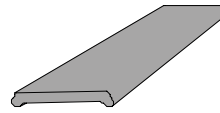

CHC-S-1921-MA

Channel Mounted Magnet

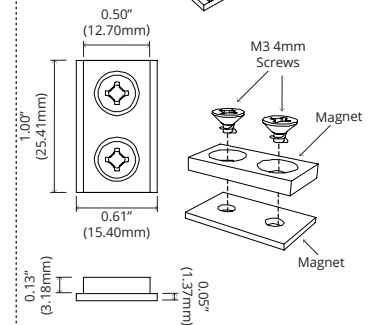
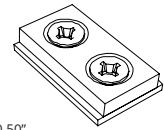

**Heating magnet past 80°C will cause irreversible loss of magnetism.*

CHC-S-1921-M

Wall Mounted Magnet

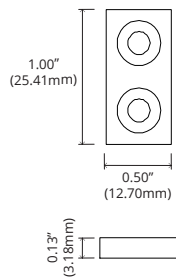
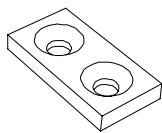

**Heating magnet past 80°C will cause irreversible loss of magnetism.*

CHC-S-1921-B1

1" Mounting Plate

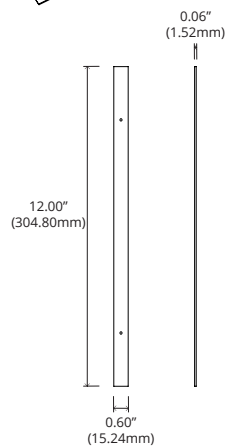
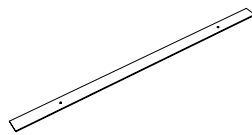

MOUNTING TO A NON-FERROUS SURFACE

ASSEMBLY

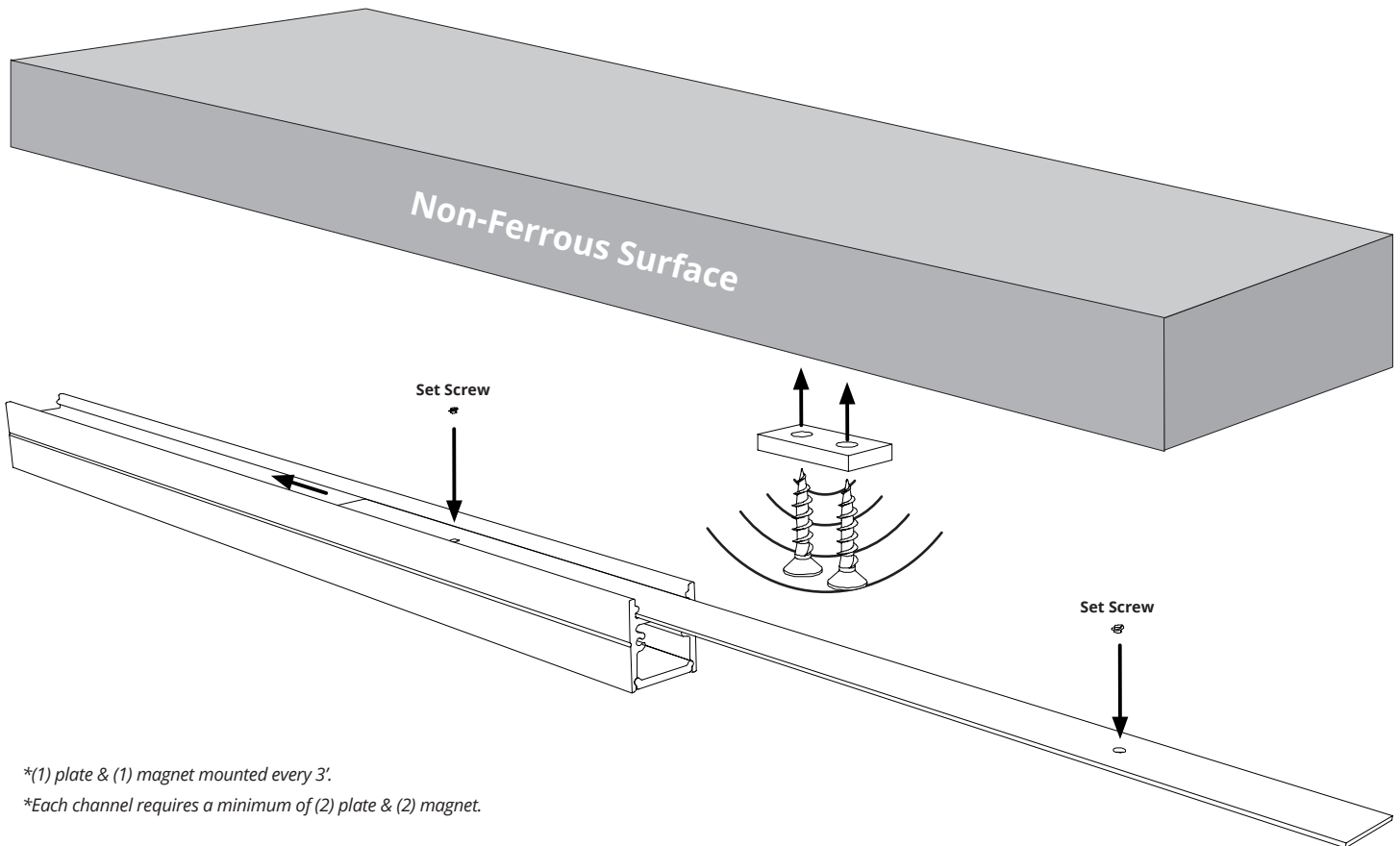

*(1) plate & (1) magnet mounted every 3'.

*Each channel requires a minimum of (2) plate & (2) magnet.

MOUNTING

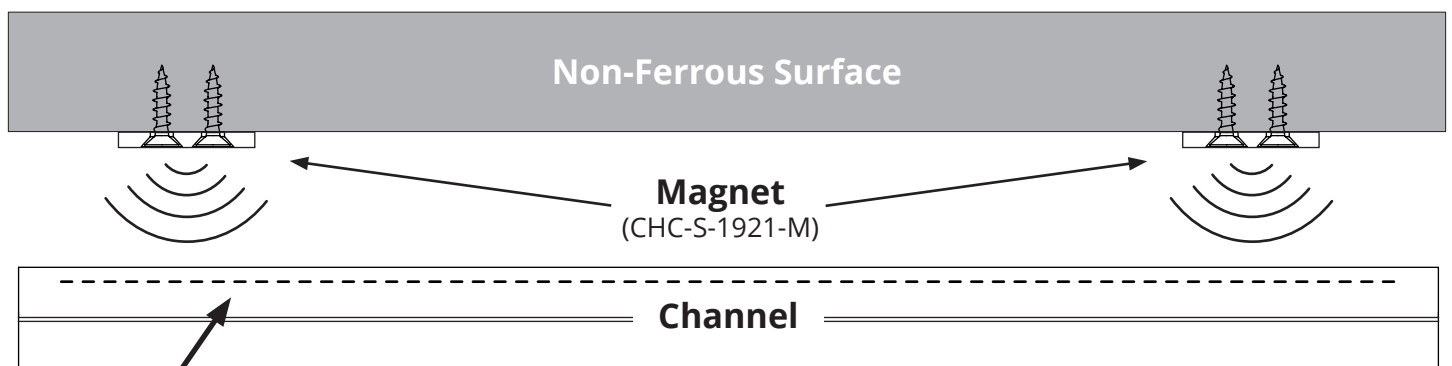

*Heating magnet past 80°C will cause irreversible loss of magnetism.

1' Mounting Plate (CHC-S-1921-B1)

MOUNTING TO A FERROUS SURFACE

ASSEMBLY

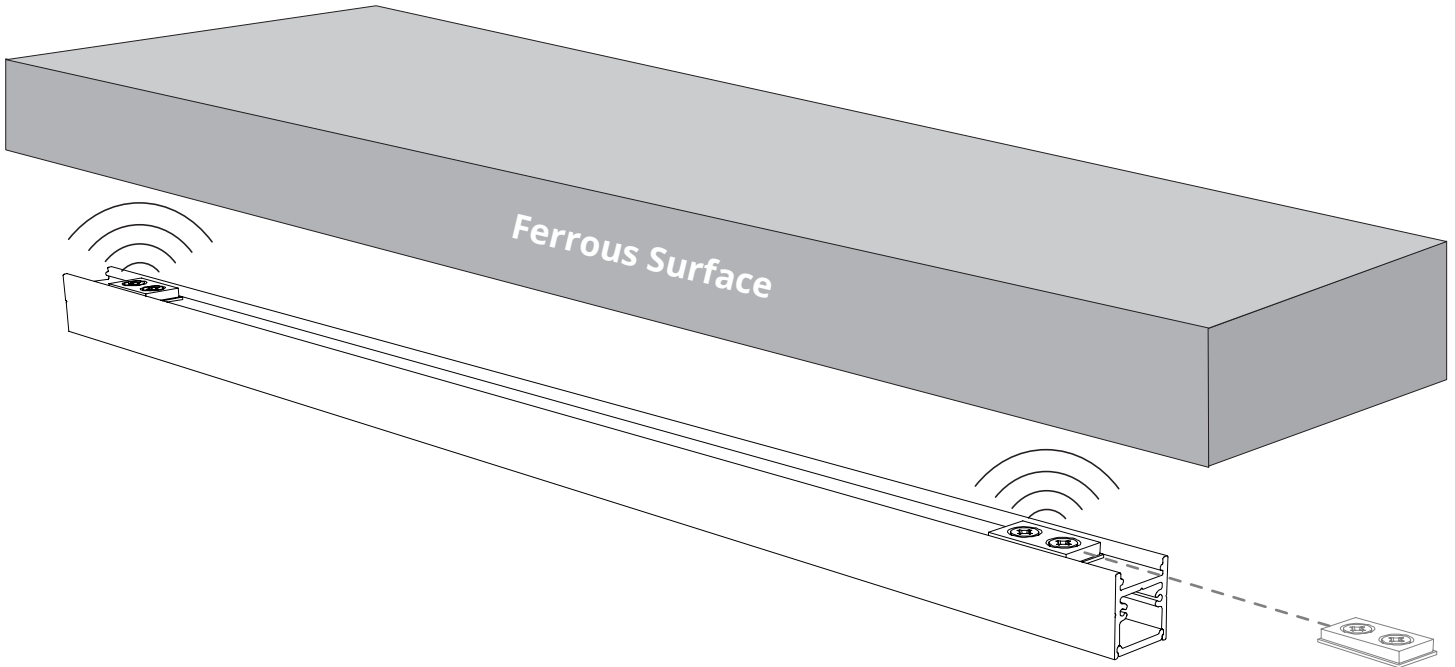

*(1) magnet mounted every 3'.

*Each channel requires a minimum of (2) magnets.

MOUNTING

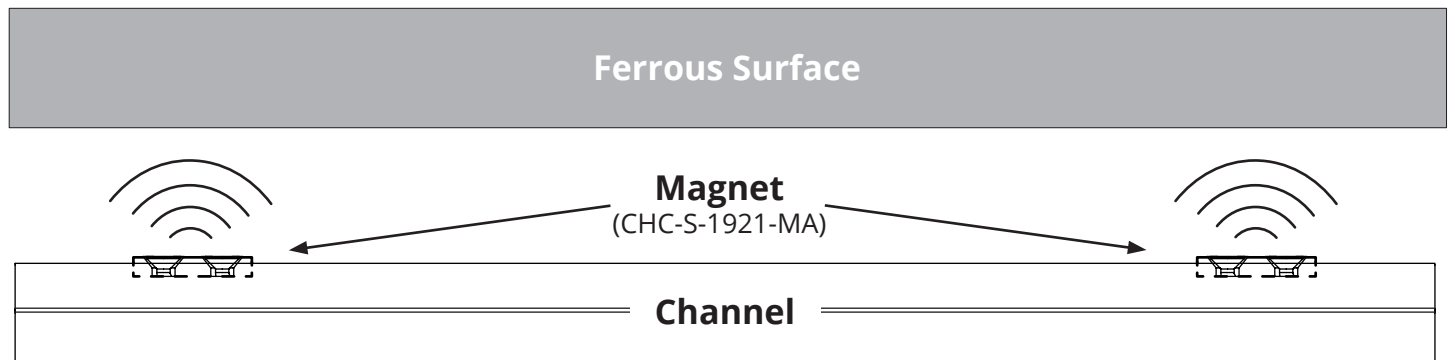

*Heating magnet past 80°C will cause irreversible loss of magnetism.