

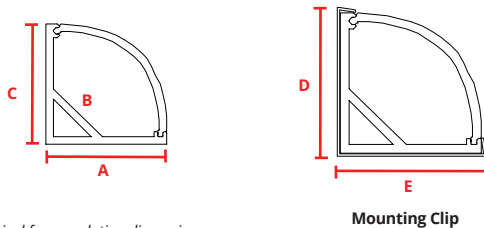

PHYSICAL

Description	Slim corner mount channel with rounded lens.
Material	Anodized Aluminum
Lens Cover	Polycarbonate
Width	A: 0.63" (16.00mm)
Inner Width	B: 0.39" (10.00mm)
Height	C: 0.63" (16.00mm)
Overall Height w/ Mounting Clip	D: 0.70" (17.78mm)
Overall Width w/ Mounting Clip	E: 0.70" (17.78mm)
Length	2 meters

DIMENSIONS



*See Physical for correlating dimensions

FINISH

Satin Silver	Red Powder Coat*
Deep Bronze Anodized*	Gray Powder Coat*
Matte Black Anodized*	Chrome*
White Powder Coat*	Custom RAL Powder Coat*
Blue Powder Coat*	

*Special order finishes may increase order lead time and incur an added cost

ACCESSORIES

	PART #
Plastic End Cap	CHS-C-1616-EC
Plastic End Cap w/Hole	CHS-C-1616-ECH
Mounting Clip	CHS-C-1616-MC
Frosted Lens	CHS-C-1616-CF
Milky Lens	CHS-C-1616-CM



Center Blend



Not Blended



Blended w/Milky Lens

COMPATIBLE FLEX PRODUCTS

FLEX DC 15		FLEX DC 30	
FLEX DC 22		FLEX DC 44	
FLEX STP 73 <i>IP20 only</i>		FLEX STP 40 <i>IP20 only</i>	
FLEX STP VARIABLE WHITE <i>IP20 only</i>		FLEX STP RGBW <i>IP20 only</i>	
FLEX STP 20 <i>IP20 only</i>			

PART NUMBER BUILDER

SERIES	+	CHANNEL TYPE	+	DIMENSIONS	+	LENS	+	FINISH
CHS = Channel Slim		C = Corner Mount Channel		1616 = H 16.00mm x W 16.00mm		2F = Frosted Lens 2M = Milky Lens		SL = Satin Silver *MB = Matte Black Anodized *BZ = Deep Bronze Anodized *WH = White Powder Coat *GY = Gray Powder Coat *BL = Blue Powder Coat *RD = Red Powder Coat *YL = Yellow Powder Coat *CH = Chrome *CR = Custom RAL Powder Coat

*Special order finishes may increase order lead time and incur an added cost

ACCESSORIES

CHS-C-1616-EC

Plastic End Cap

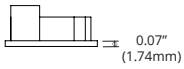
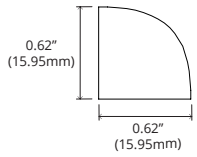
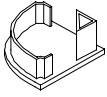

CHS-C-1616-ECH

Plastic End Cap w/Hole

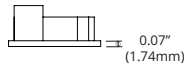
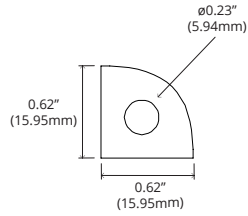
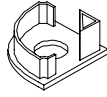

CHS-C-1616-MC

Mounting Clip

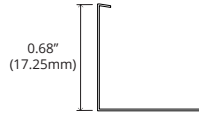
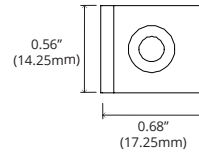
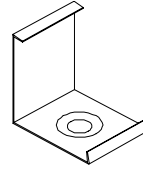

CHS-C-1616-CF

Frosted Lens

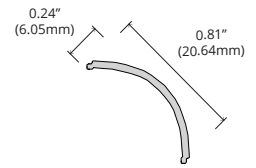
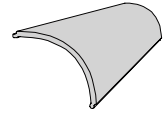

CHS-C-1616-CM

Milky Lens

