



Please read entire guide prior to starting installation.

NOTES

1. IP40 and lower tape must be installed indoors only. Installing outdoors will void the warranty.
2. Installation must be carried out by a licensed electrician & executed in accordance with local codes.
3. The installing contractor assumes all liability for the safety and code compliance of the installation.
4. Optic Arts is not liable for any damages caused by improper wiring, driver overloading, driver under-loading, power surges, poor system design or layout, negligence or other conditions.

1.

- 1.1** Prepare to mount FLEX RADIUS by removing the liner from the back of the FLEX RADIUS.
- 1.2** Start at one end of the FLEX RADIUS. Work your way down the surface, pressing the FLEX RADIUS onto the mounting surface, avoiding bubbles and creases.

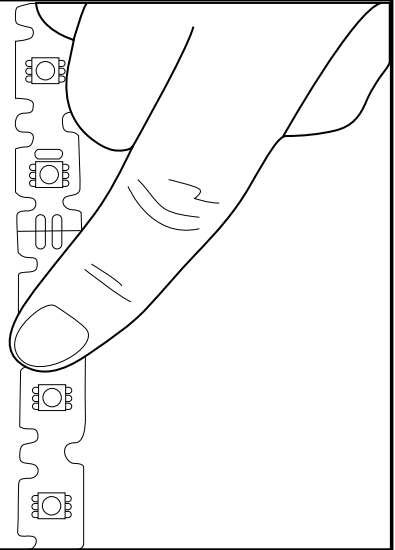

2.

- 2.1** You can bend the product and fold it over on itself up to 90° at the cutout bend points. Bending should be done once, repeated bending can damage the product.
- 2.2** Apply pressure to the entire length of FLEX DC® firmly, but gently, using your fingers.

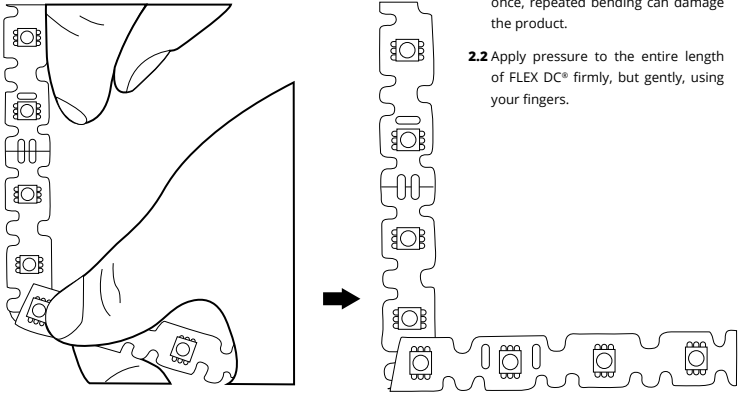

3.

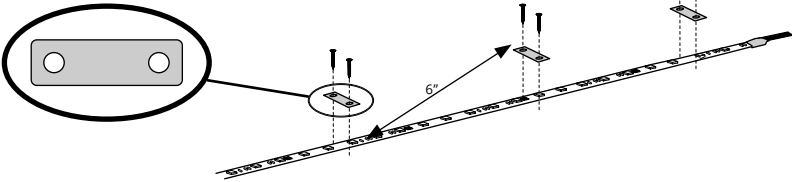

3.1 Install one FLEXMNT.SIL.INT mounting strap every 6".