

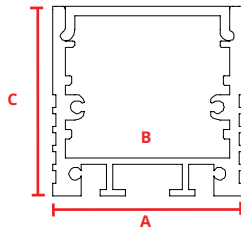

PHYSICAL

Description	Wide and deep surface mounted or hanging channel with flat lens for even blending.
Material	Anodized Aluminum
Lens Cover	Polycarbonate
Width	A: 1.18" (30.00mm)
Inner Width	B: 1.01" (25.60mm)
Height	C: 1.18" (30.00mm)
Length	2 meters

DIMENSIONS



*Must specify for hanging or surface mount application.

FINISH

Satin Silver	Red Powder Coat*
Deep Bronze Anodized*	Gray Powder Coat*
Matte Black Anodized*	Chrome*
White Powder Coat*	Custom RAL Powder Coat*
Blue Powder Coat*	

*Special order finishes may increase order lead time and incur an added cost

ACCESSORIES

	PART #
Plastic End Cap	CHW-SH-3030-EC
Plastic End Cap w/Hole	CHW-SH-3030-ECH
Hanging Hardware	CHW-SH-MW
Milky Lens	CHW-SH-3030-CM
Bracket Straight	CHW-SH-BS
Bracket 90° Flat	CHW-SH-B90F
Bracket 90° Raised	CHW-SH-B90R
End Cap for FLEX AC	CHW-SH-3030-ECAC
Mounting Clip for FLEX AC	CHW-SH-3030-MCAC

COMPATIBLE FLEX PRODUCTS



Not Blended



Blended w/Milky Lens

FLEX DC 15		FLEX DC 22	
FLEX DC 30		FLEX DC 44	
FLEX DC 88		FLEX 44 RGBW	
FLEX DC 88 RGBW <i>Fits IP40 only</i>		FLEX DC QUAD	
FLEX STP 73 <i>IP20 only</i>		FLEX STP RGBW <i>IP20 only</i>	
FLEX STP VARIABLE WHITE <i>IP20 only</i>		FLEX DC VARIABLE WHITE	
FLEX STP 40 <i>IP20 only</i>		FLEX STP 20 <i>IP20 only</i>	

PART NUMBER BUILDER

SERIES	+	CHANNEL TYPE	+	DIMENSIONS	+	LENS	+	FINISH
CHW = Channel Wide		S = Surface Mounted H = Hanging Channel		3030 = H 30.00mm x W 30.00mm		2M = Milky Lens		SL = Satin Silver *MB = Matte Black Anodized *BZ = Deep Bronze Anodized *WH = White Powder Coat *GY = Gray Powder Coat *BL = Blue Powder Coat *RD = Red Powder Coat *YL = Yellow Powder Coat *CH = Chrome *CR = Custom RAL Powder Coat

*Special order finishes may increase order lead time and incur an added cost

ACCESSORIES

CHW-SH-3030-EC

Anodized Aluminum
End Cap

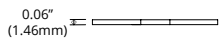
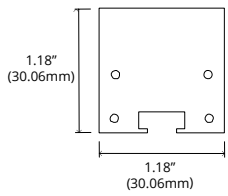
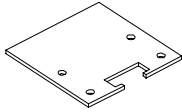

CHW-SH-3030-ECH

Anodized Aluminum
End Cap w/Hole

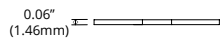
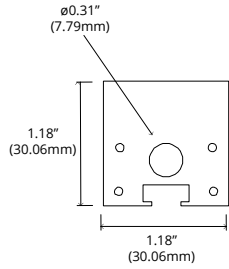
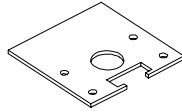

CHW-SH-3030-HHK

Hanging Hardware

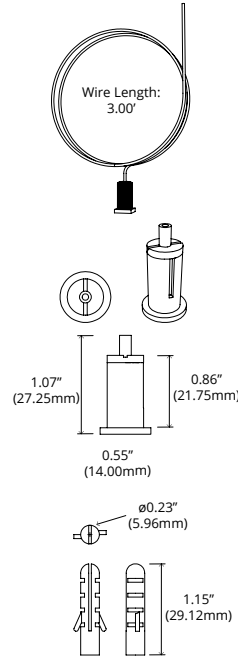

CHW-SH-3030-CM

Milky Lens

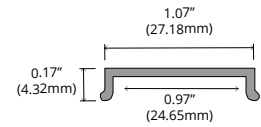
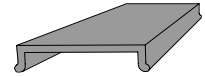

CHW-SH-BS

Bracket Straight

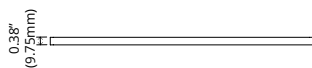
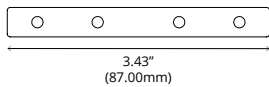
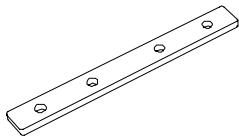

CHW-SH-B90F

Bracket 90° Flat

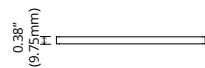
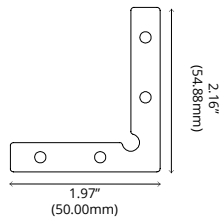
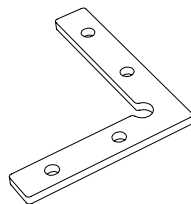

CHW-SH-B90R

Bracket 90° Raised

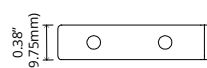
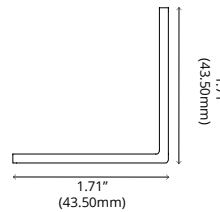
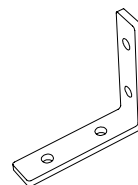

CHW-SH-3030-ECAC

End Cap for FLEX AC

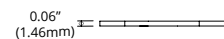
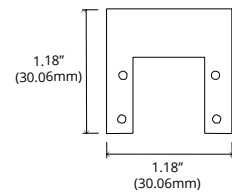
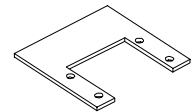

ACCESSORIES

CHW-SH-3030-MCAC

Mounting Clip for FLEX AC

