

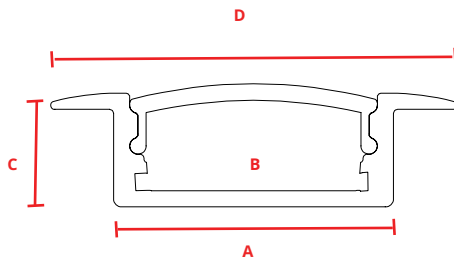

PHYSICAL

Description	Recessed wide-profile channel.
Material	Anodized Aluminum
Lens Cover	Polycarbonate
Width	A: 0.93" (23.50mm)
Inner Width	B: 0.78" (20.00mm)
Height	C: 0.39" (10.00mm)
Flange Length	D: 1.19" (30.24mm)
Length	2 meters

DIMENSIONS



FINISH

Satin Silver	*White Powder Coat
Deep Bronze	*Custom RAL Powder Coat
*Matte Black	*Chrome

*Special order finishes may increase order lead time and incur an added cost

ACCESSORIES

	PART #
Plastic End Cap	CHW-R-2010-EC
Plastic End Cap w/Hole	CHW-R-2010-ECH
Clear Lens	CHW-R-2010-CC
Frosted Lens	CHW-R-2010-CF
Milky Lens	CHW-R-2010-CM



Center Blend



Not Blended



Blended w/Milky Lens

COMPATIBLE FLEX PRODUCTS

FLEX DC 15		FLEX DC 22	
FLEX DC 30		FLEX DC 44	
FLEX DC 88		FLEX 44 RGBA/W	
FLEX DC QUAD		FLEX STP 73 <i>IP20 only</i>	
FLEX STP RGBW <i>IP20 only</i>		FLEX STP VARIABLE WHITE <i>IP20 only</i>	
FLEX DC VARIABLE WHITE		FLEX STP 40 <i>IP20 only</i>	
FLEX STP 20 <i>IP20 only</i>			

PART NUMBER BUILDER

SERIES	+	CHANNEL TYPE	+	DIMENSIONS	+	LENS	+	FINISH
CHW = Channel Wide		R = Recessed Channel		2010 = H 10.00mm x W 20.00mm		2C = Clear Lens 2F = Frosted Lens 2M = Milky Lens		SL = Satin Silver *MB = Matte Black Anodized *BZ = Deep Bronze Anodized *WH = White Powder Coat *GY = Gray Powder Coat *BL = Blue Powder Coat *RD = Red Powder Coat *YL = Yellow Powder Coat *CH = Chrome *CR = Custom RAL Powder Coat

*Special order finishes may increase order lead time and incur an added cost

ACCESSORIES

CHW-R-2010-EC

Plastic End Cap

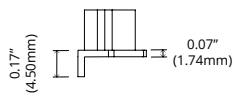
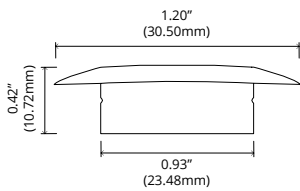
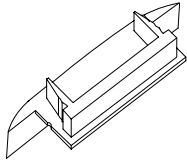

CHW-R-2010-ECH

Plastic End Cap w/Hole

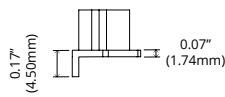
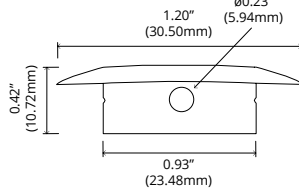
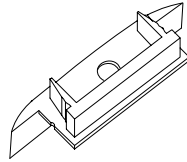

CHW-R-2010-CC

Clear Lens

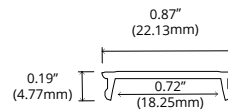
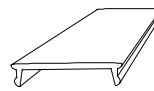

CHW-R-2010-CF

Frosted Lens

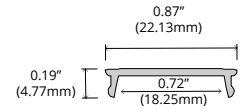
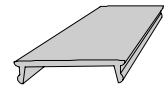

CHW-R-2010-CM

Milky Lens

