

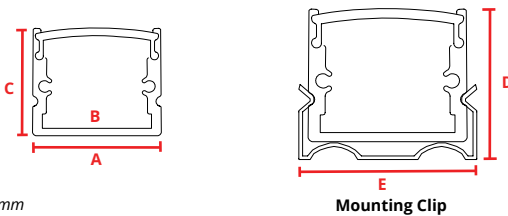

PHYSICAL

| | |
|--|--|
| Description | Slim and deep surface mounted channel. Eliminates visible LED nodes when used with FLEX DC® 3.0 & milk lens. |
| Material | Anodized Aluminum |
| Lens Cover | Polycarbonate |
| Width | A: 0.68" (17.25mm) |
| Inner Width | B: 0.48" (12.30mm) |
| Height | C: 0.59" (15.05mm) |
| Overall Height w/ Mounting Clip | D: 0.66" (16.76mm) |
| Overall Width w/ Mounting Clip | E: 0.78" (19.90mm) |
| Length | 2 meters |

DIMENSIONS



Rotating 20.4mm

*See Physical for correlating dimensions

FINISH

| | |
|-----------------------|-------------------------|
| Satin Silver | Red Powder Coat* |
| Deep Bronze Anodized* | Gray Powder Coat* |
| Matte Black Anodized* | Chrome* |
| White Powder Coat* | Custom RAL Powder Coat* |
| Blue Powder Coat* | |

*Special order finishes may increase order lead time and incur an added cost

ACCESSORIES

| | PART # |
|---|----------------|
| Anodized Aluminum End Cap | CHS-S-1715-EC |
| Anodized Aluminum End Cap w/hole | CHS-S-1715-ECH |
| Mounting Clip | CHS-S-1715-MC |
| Rotating Mounting Clip | CHS-S-1208-MCR |
| Clear Lens | CHS-12mm-CC |
| Frosted Lens | CHS-12mm-CF |
| Milky Lens | CHS-12mm-CM |
| Grazer Lens | CHS-12mm-CG |

COMPATIBLE FLEX PRODUCTS

| | Not Blended | Blended w/Milky Lens |
|---|-------------|----------------------|
| FLEX DC 15 | | |
| FLEX DC 22 <i>Fits IP40 only</i> | | |
| FLEX DC 30 <i>*Blends with IP20/40 **No Blend with IP65/67/68</i> | | |
| FLEX DC 44 <i>Fits IP40 only</i> | | |
| FLEX DC 44 RGBW <i>Fits IP40 only</i> | | |
| FLEX DC QUAD <i>Fits IP40 only</i> | | |
| FLEX STP 73 <i>IP20 only</i> | | |
| FLEX STP RGBW <i>IP20 only</i> | | |
| FLEX STP VARIABLE WHITE <i>IP20 only</i> | | |
| FLEX DC VARIABLE WHITE <i>Fits IP40 only</i> | | |
| FLEX STP 40 <i>IP20 only</i> | | |
| FLEX STP 20 <i>IP20 only</i> | | |

PART NUMBER BUILDER

| SERIES | + | CHANNEL TYPE | + | DIMENSIONS | + | LENS | + | FINISH |
|--------------------|---|---------------------------|---|------------------------------|---|---|---|---|
| CHS = Channel Slim | | S = Surface Mount Channel | | 1715 = H 17.00mm x W 15.00mm | | 2C = Clear Lens 2F = Frosted Lens 2M = Milky Lens 2G = Grazer Lens | | SL = Satin Silver *MB = Matte Black Anodized *BZ = Deep Bronze Anodized *WH = White Powder Coat *GY = Gray Powder Coat *BL = Blue Powder Coat *RD = Red Powder Coat *YL = Yellow Powder Coat *CH = Chrome *CR = Custom RAL Powder Coat |

*Special order finishes may increase order lead time and incur an added cost



ACCESSORIES

CHS-S-1715-EC

Anodized Aluminum
End Cap

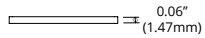
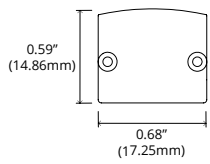
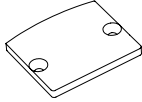

CHS-S-1715-ECH

Anodized Aluminum
End Cap w/Hole

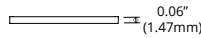
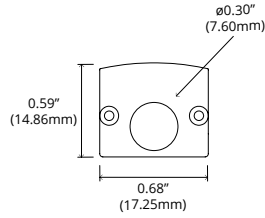
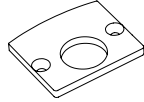

CHS-S-1715-MC

Mounting Clip

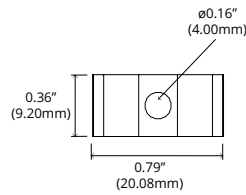
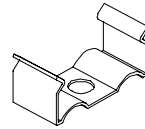

CHS-S-1208-MCR

Rotating Mounting Clip

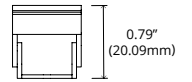
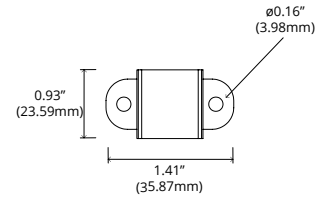
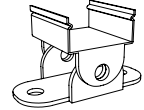

CHS-S-1715-CC

Clear Lens

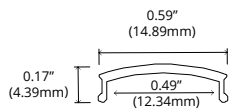
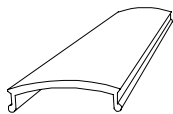

CHS-S-1715-CF

Frosted Lens

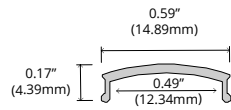
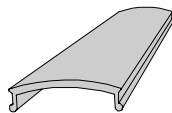

CHS-S-1715-CM

Milky Lens

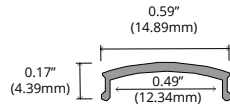
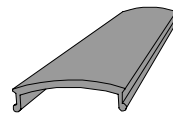

CHS-S-1715-CG

Grazer Lens

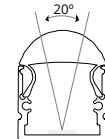
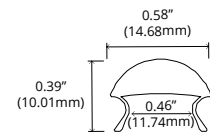
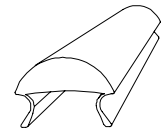

Beam Spread