

## PHYSICAL

|  |   |
|--|---|
| <b>Description</b>                     | Slim and shallow surface mount channel. |
| <b>Material</b>                        | Anodized Aluminum                       |
| <b>Lens Cover</b>                      | Polycarbonate                           |
| <b>Width</b>                           | <b>A:</b> 0.68" (17.25mm)               |
| <b>Inner Width</b>                     | <b>B:</b> 0.50" (12.59mm)               |
| <b>Height</b>                          | <b>C:</b> 0.34" (8.60mm)                |
| <b>Overall Height w/ Mounting Clip</b> | <b>D:</b> 0.40" (12.70mm)               |
| <b>Overall Width w/ Mounting Clip</b>  | <b>E:</b> 0.78" (19.90mm)               |
| <b>Length</b>                          | 2 meters                                |

## DIMENSIONS

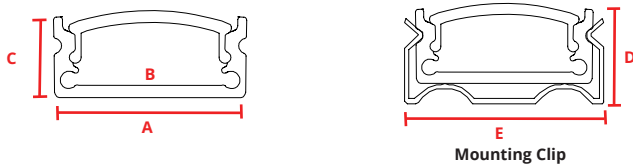

\*See Physical for correlating dimensions

## FINISH

|                       |                         |
|-----------------------|-------------------------|
| Satin Silver          | Red Powder Coat*        |
| Deep Bronze Anodized* | Gray Powder Coat*       |
| Matte Black Anodized* | Chrome*                 |
| White Powder Coat*    | Custom RAL Powder Coat* |
| Blue Powder Coat*     |                         |

\*Special order finishes may increase order lead time and incur an added cost

## ACCESSORIES

|   | PART #         |
|---|----------------|
| <b>Anodized Aluminum End Cap</b>        | CHS-S-1208-EC  |
| <b>Anodized Aluminum End Cap w/hole</b> | CHS-S-1208-ECH |
| <b>Mounting Clip</b>                    | CHS-S-1208-MC  |
| <b>Rotating Mounting Clip</b>           | CHS-S-1208-MCR |
| <b>Clear Lens</b>                       | CHS-12mm-CC    |
| <b>Frosted Lens</b>                     | CHS-12mm-CF    |
| <b>Milky Lens</b>                       | CHS-12mm-CM    |
| <b>Grazer Lens</b>                      | CHS-12mm-CG    |



## COMPATIBLE FLEX PRODUCTS

|  |  |  |  |
|--|--|--|--|
| <b>FLEX DC 15</b>                                  |  | <b>FLEX DC 22</b><br><i>Fits IP40 only</i>             |  |
| <b>FLEX DC 30</b><br><i>Fits IP40 only</i>         |  | <b>FLEX DC 44</b><br><i>Fits IP40 only</i>             |  |
| <b>FLEX DC 44 RGBW</b><br><i>Fits IP40 only</i>    |  | <b>FLEX DC QUAD</b><br><i>Fits IP40 only</i>           |  |
| <b>FLEX STP 73</b><br><i>IP20 only</i>             |  | <b>FLEX STP RGBW</b><br><i>IP20 only</i>               |  |
| <b>FLEX STP VARIABLE WHITE</b><br><i>IP20 only</i> |  | <b>FLEX DC VARIABLE WHITE</b><br><i>Fits IP40 only</i> |  |
| <b>FLEX STP 40</b><br><i>IP20 only</i>             |  | <b>FLEX STP 20</b><br><i>IP20 only</i>                 |  |

## PART NUMBER BUILDER

| SERIES             | + | CHANNEL TYPE              | + | DIMENSIONS                  | + | LENS  | + | FINISH  |
|--------------------|---|---------------------------|---|-----------------------------|---|---|---|---|
| CHS = Channel Slim |   | S = Surface Mount Channel |   | 1208 = H 8.00mm x W 12.20mm |   | 2C = Clear Lens<br>2F = Frosted Lens<br>2M = Milky Lens<br>2G = Grazer Lens |   | SL = Satin Silver<br>*MB = Matte Black Anodized<br>*BZ = Deep Bronze Anodized<br>*WH = White Powder Coat<br>*GY = Gray Powder Coat<br><br>*BL = Blue Powder Coat<br>*RD = Red Powder Coat<br>*YL = Yellow Powder Coat<br>*CH = Chrome<br>*CR = Custom RAL Powder Coat |

\*Special order finishes may increase order lead time and incur an added cost



## ACCESSORIES

### CHS-S-1208-EC

Anodized Aluminum  
End Cap

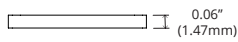
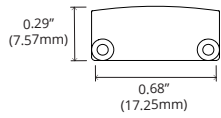
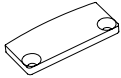

### CHS-S-1208-ECH

Anodized Aluminum  
End Cap w/Hole

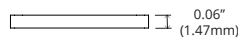
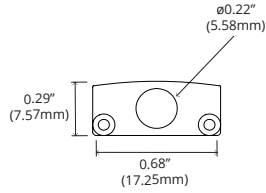
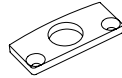

### CHS-S-1208-MC

Mounting Clip

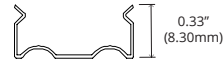
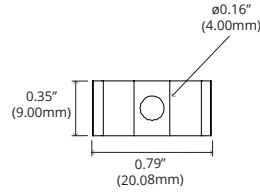
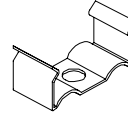

### CHS-S-1208-MCR

Rotating Mounting Clip

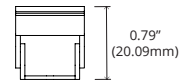
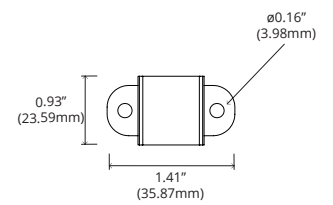
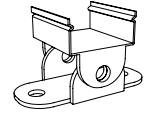

### CHS-S-1208-CC

Clear Lens

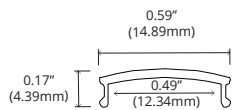
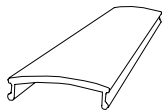

### CHS-S-1208-CF

Frosted Lens

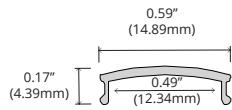
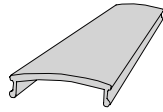

### CHS-S-1208-CM

Milky Lens

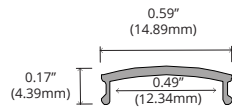
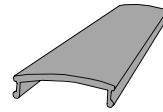

### CHS-S-1208-CG

Grazer Lens

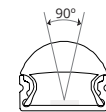
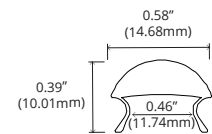
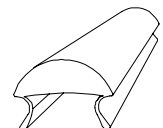

Beam Spread