

Plexineon Rings

Surface Mount

RGB, RGBW and RGBW Pixel



Horizontal Ring
RGBW-Pixel

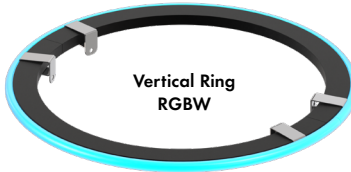

Vertical Ring
RGBW

- Easy to install, for interior and exterior accent lighting
- Neon look providing a crisp, clear line of light visible for miles
- Mounting Clips are included in the appropriate quantities
- Operating Temperature: -40° F to 140° F (-40° C to 60° C)
- 24VDC Class 2
- IK10 and 3G rated
- IP67 rated. IP68 rating available upon specific request
- 5 year warranty indoor, 3 year warranty outdoor

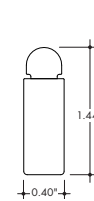

Without Mounting Clip

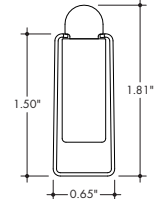

With Mounting Clip



Technical Information

| RING OUTER DIAMETER* (inch) | | Plexineon RGB | Plexineon RGBW | Plexineon Pixel RGBW |
|-----------------------------|--------------------------|---------------|----------------|----------------------|
| EFFICACY | | 17.5 lm/W | 17.1 lm/W | 14.7 lm/W |
| Ø36 (Ø3ft) | Lumen Output | 679 lm | 792 lm | 792 lm |
| | Power Consumption | 38.6 W | 46.2 W | 53.7 W |
| Ø72 (Ø6ft) | Lumen Output | 1357 lm | 1583 lm | 1583 lm |
| | Power Consumption | 77.2 W | 92.3 W | 107.4 W |
| Ø144 (Ø12ft) | Lumen Output | 2714 lm | 3166 lm | 3166 lm |
| | Power Consumption | 154.6 W | 184.7 W | 214.9 W |
| Ø288 (Ø24) | Lumen Output | 5429 lm | 6333 lm | 6333 lm |
| | Power Consumption | 309.1 W | 369.5 W | 429.8 W |

| RGBW (3000K) | | | | |
|--------------|-----|----------------|----------------|----------------|
| Model | CRI | TM-30 | | |
| | | R _f | R _g | R _g |
| RGBW | 85 | 84 | 98 | 22 |
| RGBW-PXSPI | 85 | 84 | 98 | 22 |

| Dominant Wavelength | |
|---------------------|-------|
| Color | RGB |
| Red | 622nm |
| Green | 525nm |
| Blue | 468nm |

All channels full on.

*Rings will be made of equal sections no longer than 96" arc length. Rings exceeding 96W will have allowances for additional power feeds.

Ordering Code

| MODEL | RING DIAMETER ¹ | RING TYPE | CCT | OUTPUT | LENS | MOUNTING ³ | FINISH | POWERFEED POSITION/TYPE |
|--------------|---|---|---|---------------|-------------|---|--|--|
| PX-Plexineon | - Ring diameter in inches, 6"-288" (24ft) | HR - Horizontal Ring VR - Vertical Ring ² | RGB - RGB RGBW - RGBW (3000K) RGBW-PXSPI - RGBW Pixel Control (3000K) | SO - Standard | F - Frosted | SM - Surface Mount SML - Surface Mount, L-Tab Clips SMS - Surface Mount, S-Tab Clips SMD - Surface Mount Decorative Clips ⁴ | GG - Gloss Grey BK - Matte Black GY - Matte Grey WH - Matte White | B-4 - Male Quick Connect One End, Female Quick Connect Other End |

1. Rings will be made of equal sections no longer than 96" arc length. Tolerance on size of diameter is +/- 1".
 2. Vertical Rings are Convex Bends with the light directed outwards, min diameter 24".
 3. 2 mounting clips included for every 12" of diameter, with a minimum of 3 clips.
 4. Decorative Clips match the fixture finish.

Plexineon Rings

Surface Mount

RGB, RGBW and RGBW Pixel



Finish Options

BK
Matte Black Finish

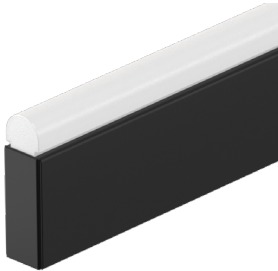

WH
Matte White Finish



GY
Matte Grey Finish

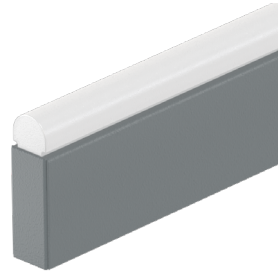

GG
Gloss Grey Finish

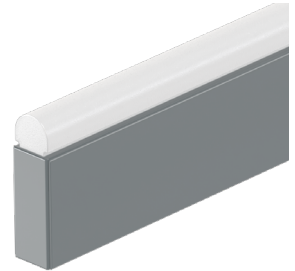

Mounting Clips

- Mounting Clips are included with Plexineon runs in the appropriate quantity, every 30" of linear/arc length for Standard Clips and every 18" of linear/arc length for Decorative Clips.
- Standard Clips have a stainless steel finish, Decorative Clip finishes match the fixture finishes.
- Standard Clip mounting hole is $\varnothing 0.2"$, Decorative Clip mounting hole is $\varnothing 0.16"$.

SM
75-CLP16-001-00
Surface Mount, Standard Clip

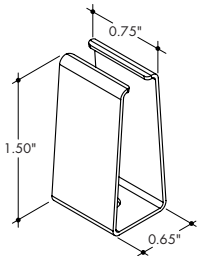

Used for mounting direct to surfaces

SML
75-CLP15-001-00
Surface Mount, L-Tab Clip

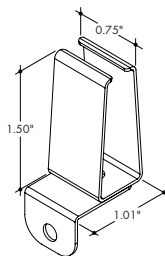

Used for mounting to adjacent surfaces

SMS
75-CLP17-001-00
Surface Mount, S-Tab Clip

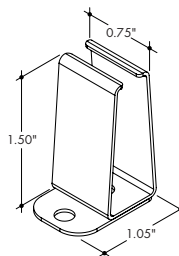

Used for to reduce install time and mounting direct to surfaces with fixture pre-assembled to clips

75-CLP19-001-00
Surface Mount, Standard Joiner Clip

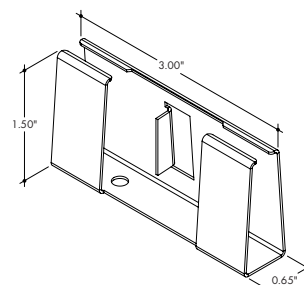

Used to join two fixtures together

SMD
75-CLP36-001-0X
Surface Mount, Decorative Clip

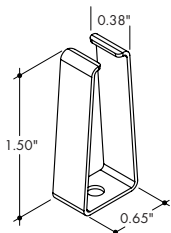

Thinner clip with finish options to match fixtures

75-CLP37-001-0X
Surface Mount, Decorative Joiner Clip

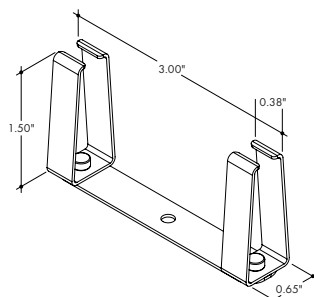

Thinner clip with finish options to match and join two fixtures together for a continuous run

70-TOL02-001-01
Mounting Clip Installation Tool

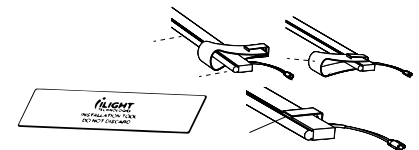

Use for installation of Plexineon into Mounting Clips

| OX | Clip Finish |
|----|-----------------|
| 00 | Stainless Steel |
| 01 | Matte Black |
| 02 | Matte Grey |
| 03 | Matte White |

Plexineon Rings

Surface Mount

RGB, RGBW and RGBW Pixel



Ring Types

HR
Horizontal Ring

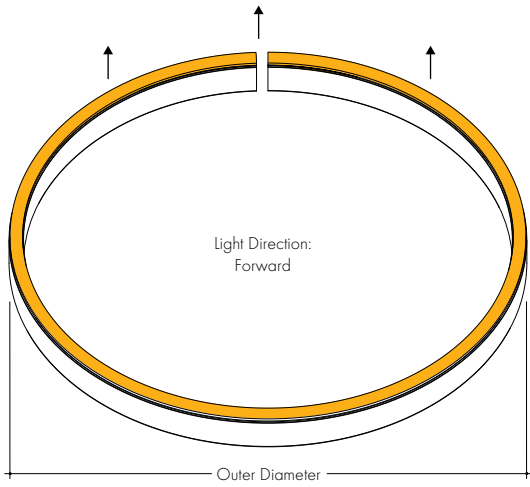

VR
Vertical Ring

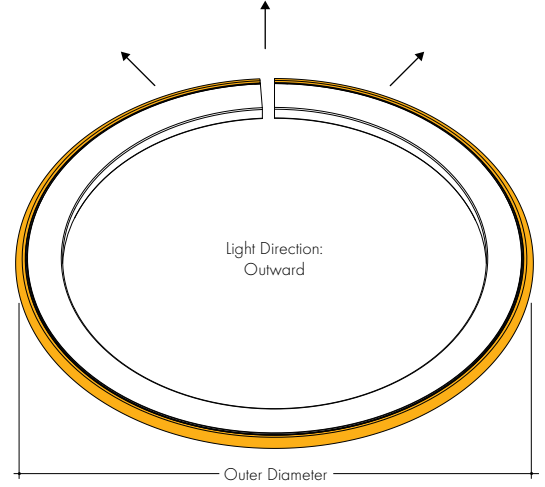

Sample Layout

PX-48-HR-RGBW-PXSPI-SO-F-SM-GG-B-4
Plexineon Horizontal Ring, Standard Mounting Clips

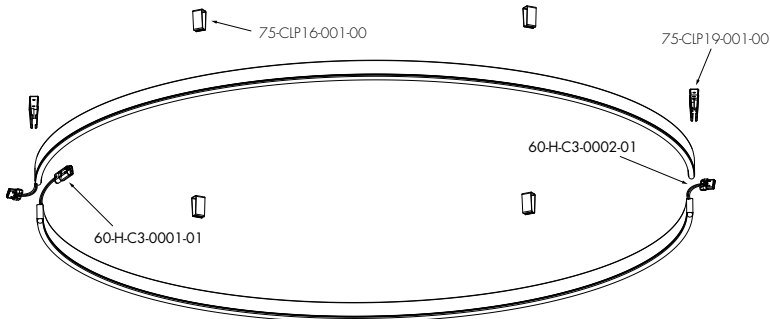

PX-32-VR-RGBW-PXSPI-SO-F-SM-GG-B-4
Plexineon Vertical Ring, Standard Mounting Clips

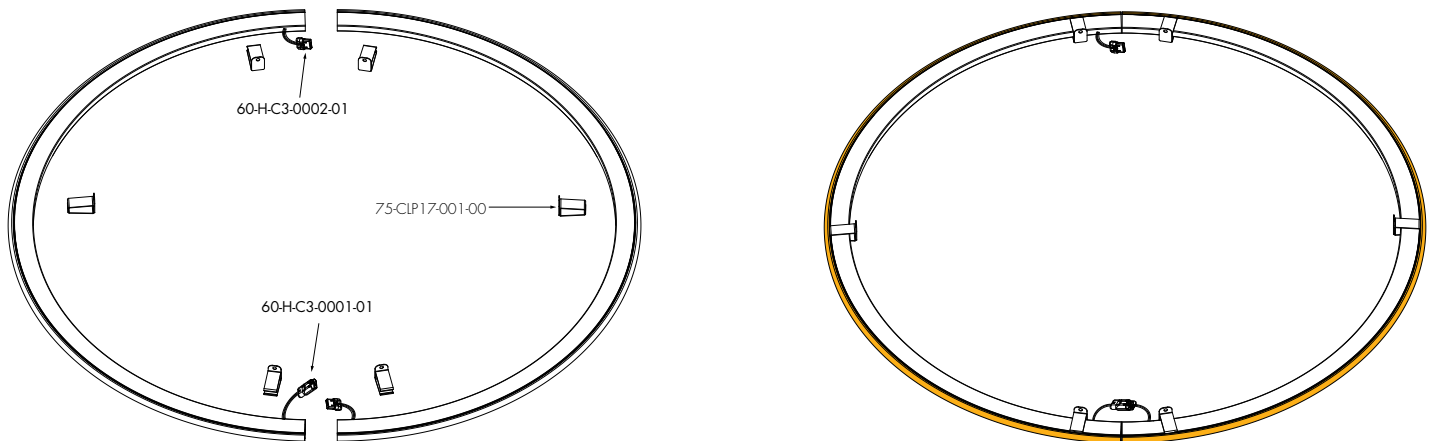

Plexineon Rings

Surface Mount

RGB, RGBW and RGBW Pixel



Powerfeed and Connectors

For use with RGB

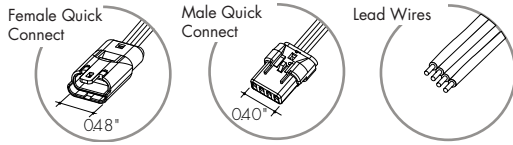

60-H-C4-0001-01
Female RGB Quick Connect
with 6" flying leads

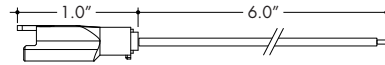

Female Quick Connect with flying leads can be connected to the Power Supply at the start of a run. Can also be used with the Male Quick Connect to make wire jumpers.

60-H-C4-0002-01
Male RGB Quick Connect
with 6" flying leads

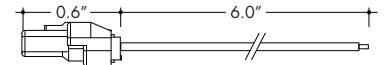

Male Quick Connect with flying leads can be used to make wire jumpers.

For use with RGBW

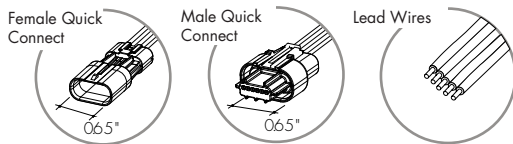

60-H-C5-0001-01
Female RGBW Quick Connect
with 6" flying leads

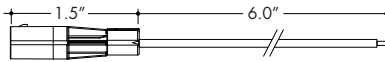

Female Quick Connect with flying leads can be connected to the Power Supply at the start of a run. Can also be used with the Male Quick Connect to make wire jumpers.

60-H-C5-0002-01
Male RGBW Quick Connect
with 6" flying leads

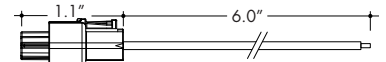

Male Quick Connect with flying leads can be used to make wire jumpers.

For use with Pixel

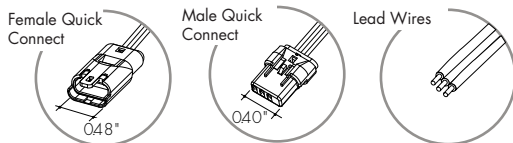

60-H-C3-0001-01
Female Pixel Quick Connect
with 6" flying leads

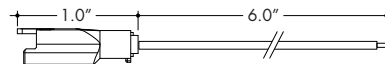

Female Quick Connect with flying leads can be connected to the Power Supply at the start of a run. Can also be used with the Male Quick Connect to make wire jumpers.

60-H-C3-0002-01
Male Pixel Quick Connect
with 6" flying leads

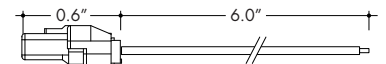

Male Quick Connect with flying leads can be used to make wire jumpers.

Also available with longer Flying Leads

60-H-C3-0005-01
Female Pixel Quick Connect
with 384" flying leads

Also available with longer Flying Leads

60-H-C3-0006-01
Male Pixel Quick Connect
with 384" flying leads

Additional Material

60-12-22AWGSBWN
Weatherproof Wire Nut
Silicone Filled

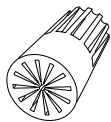

Order 2 per Power Supply.

55-STW02-050-00
50 ft of 14 gauge wire Black jacket,
2 conductors

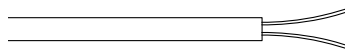

Sunlight, moisture resistant, and flame retardant PVC jacket per UL 1277

Plexineon Rings

Surface Mount

RGB, RGBW and RGBW Pixel



Common Applications

Custom Indoor Designs | Covers | Signs | Building Facades | Lobbies | Hallways | Statement Pieces | Restaurants
Corporate Offices | Schools | Residential Towers | Parking Garages | Hotels | Bridges | Benches | Airports



Plexineon Rings

Surface Mount

RGB, RGBW and RGBW Pixel

Power Supplies

See fixture and power supply instructions & spec sheet for wiring information. Dimming possible in select models - view luminii website for list of compatible dimmers.

For use with RGB/RGBW/Pixel

Non-Dimming Power Supply 120VAC - 277VAC

| MODEL | POWER | OUTPUT | DIMMING | LOCATION |
|----------------|------------|-----------|----------------|----------------|
| PSV-PSV Series | 96-96 Watt | 24-24 VDC | ND-Non Dimming | D-Dry location |

Requires a controller and a decoder to work properly

| MODELS | 96W |
|--------|-------|
| Length | 8.25" |
| Width | 4.10" |
| Depth | 1.56" |

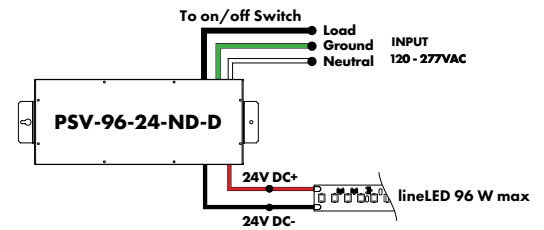

For use with RGB/RGBW

DMX 0% Dimming Power Supplies 120VAC - 277VAC

| MODEL | POWER | OUTPUT |
|--|------------------------------------|-----------|
| PSDMX-DMX Power Supply dims down to 0% | 96 - 96 Watt 3X96 - 3 X 96 Watt | 24-24 VDC |

Features eldoLED's LINEARdrive configurable dimmable drivers.

DDMX-RGBW DMX Decoder not required when purchasing this power supply.

| MODELS | 96W | 3X96 |
|--------|--------|--------|
| Length | 14.40" | 15.75" |
| Width | 5.20" | 6.62" |
| Depth | 2.60" | 4.95" |

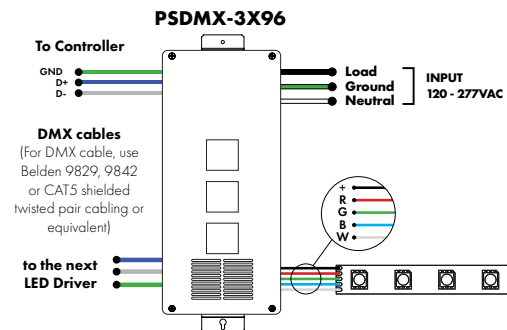
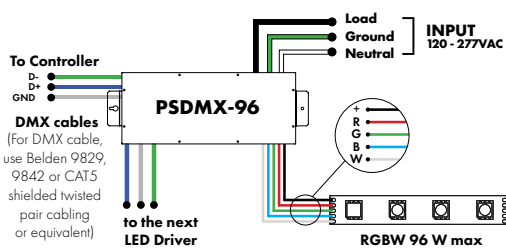

Plexineon Rings Surface Mount

RGB, RGBW and RGBW Pixel



DMX-1Z-RGBW, DMX-3Z-RGBW

RGBW LED 1 or 3 Zone Controller



ORDERING CODE

| MODEL | ZONES | COLOR |
|----------------------|----------------------------------|----------------------------------|
| DMX - DMX Controller | 3Z - Three Zone 1Z - One Zone | RGBW - Red, Green, Blue, & White |

DMX /Wireless RGB-W wall-mount controller controls DMX lighting fixtures, wireless control of RGB-W lighting fixture or use both simultaneously. Fits in any standard US switch box. Includes all the outputs in the back of the controller.

Control brightness levels with a single touch, personalize and memorize 3 different scenes, and even create 3 variations of white.

Features

- 2 in 1 in-Wall Controller: DMX Control or Wireless RGB-W
- 65,000 Color Options, Dimming and Speed Control
- Memory Function
- 50 Foot Wireless Range
- Easily Fits Standard US Switch Boxes
- Touch Sensitive Glass Surface
- Includes 10 Built in Programs, or Create and Play Your Own

Operating Voltage

12 - 24V DC

Color Parameters

- Brightness
- Saturation
- Primary colors
- Fading
- Color changing speed

Touch DMX Controller

Touchscreen digital LED controller

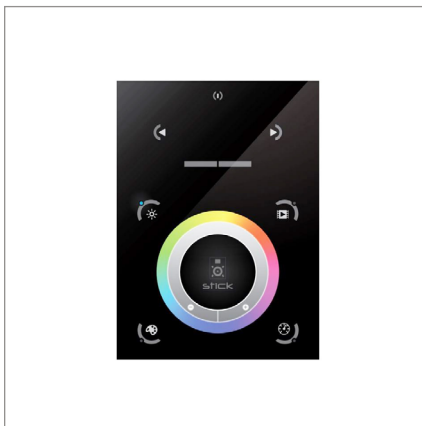

ORDERING CODE

| MODEL |
|---------|
| TSDMX-E |

TSDMX-E - Touchscreen DMX controller

Programmable advanced DMX512 lighting controller featuring a touch-screen interface. Operates as stand alone controller or integrated with most architectural lighting control systems. Can controller endless DMX512 enabled devices.

Mounts to standard single or dual gang wall box with the included power supply inside the junction box. Terminal block design for power and data connections.

Features

- Sleek glass design which sits 0.43" from the wall
- Graphical color display to show selected environment
- Color/dimmer/speed palette
- Color temperature mixing
- Touch sensitive buttons. No mechanical parts
- Touch sensitive wheel allows for accurate color selection
- Multi-zone microSD memory
- Multi-room control with 500 scenes, 10 zones
- 1024 DMX channels. Control 340 RGB fixtures
- USB & Ethernet connectivity for programming and control

Power Supply

7 VDC (included)

Programmability

PC, Mac, Tablet, Smartphone

Output Signal

DMX512 (1024 channels)

Color Parameters

- Brightness
- Saturation
- Speed of color changing sequence
- Fading / dimming / brightness

Plexineon Rings Surface Mount

RGB, RGBW and RGBW Pixel

DMX Decoder

DMX signal to RGBW decoder (required to operate DMX controller)

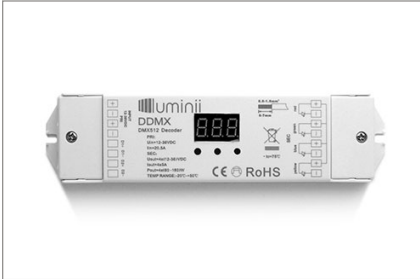

ORDERING CODE

MODEL

DDMX-RGBW

DDMX-RGBW - DMX decoder

Translates controller DMX512 programs for RGB and white LED strips.

Unique DMX address for the decoder can be set easily and displayed by the numeric display on the case. Changing and resetting the DMX address requires manual input.

Use power repeater to expand output.

Operating Voltage

12-36 VDC

Power Capacity

up to 96W at 24V

Operating Temperature Range

from -4°F to +122°F in case

Smart Pixel Decoder

SPI signal to DMX signal decoder



ORDERING CODE

MODEL

SR-DMX-SPI

SR-DMX-SPI - Smart Pixel Decoder

The SR-DMX-SPI is a smart LED pixel decoder that controls RGB/RGBW pixel LED strips with SPI signal. Designed with an OLED backlit panel, the pixel controller allows for easy configuration of most settings. Four push buttons are available for control of the LED functions.

* For pixel only.

Features

- 2 in 1 in-Wall Controller: DMX Control or Wireless RGB-W
- SPI signal output for RGB/RGBW pixel light control
- DMX512 controllable and RF/WIFI remote controllable
- Capable of addressing up to 1020 RGB pixels & 765 RGBW pixels
- OLED panel allows for easy configuration

Operating Voltage

12 - 36V DC

Power capacity

up to 96W at 24V

Operating temperature range

from -4°F to +122°F in case