

### Features

The LineLED WD68 Wet Tube is a small profile, excellent color quality, energy efficient Warm Dim LED Strip for IP65, IP67, and IP68 rated wet installations. LineLED WD86 Wet Tube follows the incandescent dimming curve from 2700K at full brightness down to 1900K at the lowest dim levels. Compatibility with MLV, ELV, and Incandescent dimmers simplifies installation.

To maintain IP65, IP67, and IP68 ratings, LineLED WD68 Wet Tube is factory sealed and bonded. Order in exact lengths required for install, LineLED WD68 Wet Tube is not field cuttable.

IP Rating of strip is equal to the lowest IP rating of section start and end options



### Mounting

LED strip is equipped with 3M™ self-adhesive tape.

### Operating voltage

24 VDC

### Applications

Outdoor and wet locations - cove lighting, architectural accent, handrail, wet bars.

### Average Life (L70)

50,000 hours

### Warranty

5 years

### Approvals

IP65, IP67, IP68 rated



### Technical information

<b>TYPE</b>	<b>LLWD68WET-T</b>
<b>OUTPUT OPTIONS</b>	<b>19K-27K</b>
Lumens Output (3000k)	313 lm/ft
Average Power Consumption (for a 4' section)	5.4 W/ft
Efficacy	58 lm/W
Max Run Length (in series)	20 ft
Cutting increment	2.46"
Pitch length	0.18"
Dimensions	0.53" W x 0.27" H

CCT	CRI	TM-30		
		R <sub>f</sub>	R <sub>g</sub>	R <sub>9</sub>
1900K	96	92	96	94
2400K	97	96	103	98
2700K	96	93	106	95

### Section Start/End Options

#### SL65

72" Soldered Leads, IP65 rated

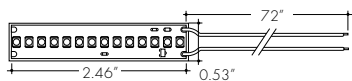

#### SL68

72" Soldered Leads, IP68 rated

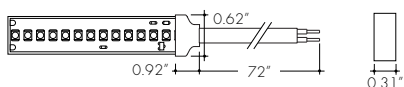

#### LF

Female Quick Connect End, IP67 rated

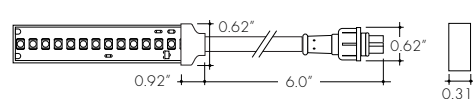

#### LM

Male Quick Connect End, IP67 rated

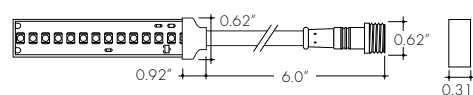

#### NC

No Connector



IP65 rated when used with SL65 selection

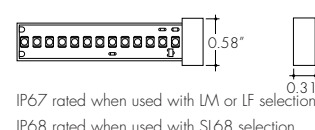

IP67 rated when used with LM or LF selection  
IP68 rated when used with SL68 selection

### Ordering code

MODEL	CCT	SECTION START <sup>1</sup>	SECTION END <sup>1</sup>	LENGTH
LLWD68WETT-LineLED WD68 Warm Dim Wet Tube	19K-27K-1900K:2700K	SL65-IP65 Soldered lead wires (72") SL68-IP68 Soldered lead wires (72") LF-IP67 Female Quick Connect LM-IP67 Male Quick Connect NC-No Connector	SL65-IP65 Soldered lead wires (72") SL68-IP68 Soldered lead wires (72") LF-IP67 Female Quick Connect LM-IP67 Male Quick Connect NC-No Connector	Ordered in one foot increments. See chart above for max run length.

<sup>1</sup> - IP rating of strip is equal to the lowest IP rating of section start and end options.

### Accessories

#### LVSP-WET

Splice box: wet rated, low voltage, gray

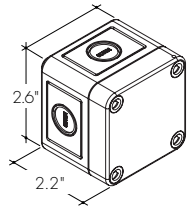

#### LVSP-WET-CM

Splice box connector, low voltage, gray

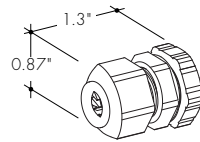

#### CL2

Mounting clip

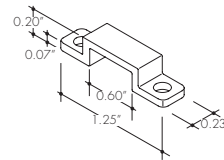

Recommended every 12" when LineLED strip is facing down

#### LL.ZIP

Strain relief clip

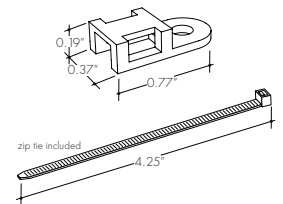

### Lens Options / Light Transmission



Clear



Half (50%)  
Frosted



Graze



Frosted



Flat  
Frosted



Raised



Square  
Frosted



Round Square  
Frosted



13°  
Semi-Frosted

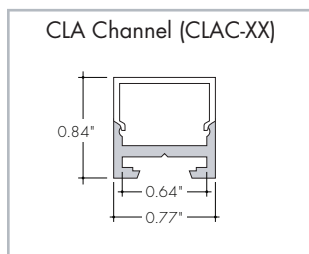

**S** **Q**  
62% 65%

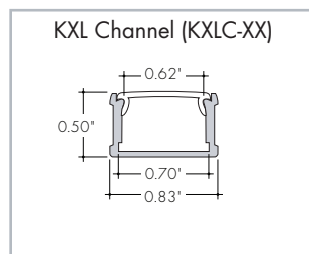

**C** **HF** **F**  
81% 67% 51%

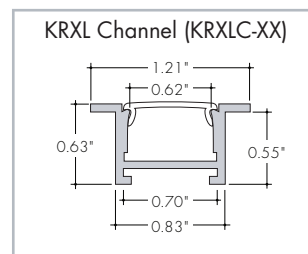

**C** **HF** **F**  
81% 67% 51%

Not compatible with LF, LM, or IP68 selections

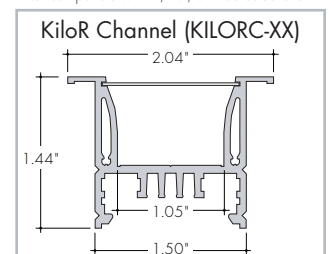

**C** **F**  
85% 75%

Not compatible with LF, LM, or IP68 selections

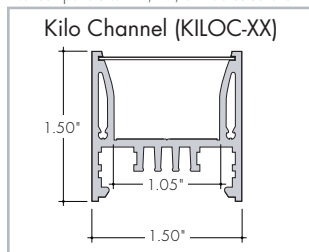

**C** **F**  
85% 75%

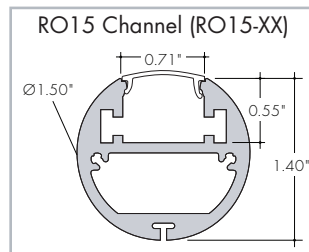

**C** **F**  
65% 41%

Not compatible with LF, LM, or IP68 selections

Not compatible with LF, LM, or IP68 selections

### Installation

All mounting channels are field cuttable using miter saw with circular blade suitable for cutting aluminum.

### Ordering

Extrusions are sold separately. View respective specsheets for details on ordering extrusions and their accessories (endcaps, mounting brackets, etc).

### Led Dotting per Extrusion

using the frosted lens option

Extrusion	LED Models
	LLWD68-WET-T
<b>KL</b>	ND
<b>KXL</b>	ND
<b>CLA</b>	ND
<b>KRL</b>	ND
<b>KRXL</b>	ND
<b>RO15</b>	ND

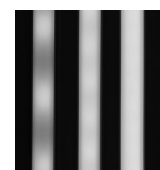

**CD** **SD** **ND**  
CD - Clear Dotting  
SD - Slight Dotting  
ND - No Dotting

**Warm Dim Curve**

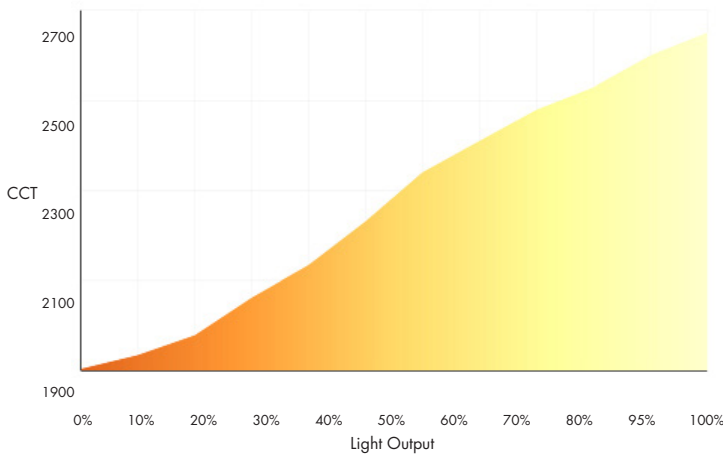

Brand	Model Part Number	Dimming Type	Dimming Range
Lutron	DIVA DVLV-603P	MLV	0 – 100
Lutron	DIVA DVLV-153P	MLV	0 – 100
Lutron	MRF2-6ELV-120	MLV	0 – 100
Lutron	MAESTRO WIRELESS MRF2-6ND-120	MLV	0 – 100
Lutron	SKYLARK CTCL-153P CFL/LED	MLV	0 – 100
Lutron	NOVA NVL-1000	MLV	0 – 100
Lutron	SKYLARK SLV-600P	MLV	0 – 100
Lutron	LUTRON PD-10NXD	ELV, INCAND, MLV	0 – 100
Leviton	LEVITON DECORA LED, CFL, INC	ELV, INCAND, MLV	0 – 100
Leviton	IP106-1L2 INCANDESCENT		0 – 100
Leviton	LEVITON AWSMT-MAW INC	MLV	0 – 100

**Dimming Table**

Voltage (V)	Dim %	Flux (lm)	CCT (K)	R9
18.5	1%	15	1904	95
19.4	10%	153	1935	95
20.3	20%	306	1979	98
21	30%	460	2062	99
21.5	40%	613	2135	98
22.2	50%	767	2232	97
22.9	60%	920	2340	96
23.5	70%	1073	2410	96
23.8	80%	1227	2479	95
24.3	90%	1348	2529	96
24.8	100%	1534	2650	95

## Power Consumption

Tested at full power with PDC Series power supplies.

Nominal Length (in)	LLWD68WET-T-19K-27K	
	W/ft	Total wattage
<b>1</b>	5.7	5.8
<b>2</b>	5.5	11.3
<b>3</b>	5.4	16.7
<b>4</b>	5.4	22.0
<b>5</b>	5.3	26.1
<b>6</b>	5.2	30.9
<b>7</b>	5.1	35.7
<b>8</b>	5.1	40.5
<b>9</b>	5.0	44.8
<b>10</b>	4.9	49.1
<b>11</b>	4.8	53.3
<b>12</b>	4.7	57.0
<b>13</b>	4.7	60.2
<b>14</b>	4.6	64.0
<b>15</b>	4.5	67.3
<b>16</b>	4.4	70.9
<b>17</b>	4.4	74.4
<b>18</b>	4.3	77.0
<b>19</b>	4.2	80.1
<b>20</b>	4.1	82.9

## Voltage Drop Calculator

The below chart assumes nominal voltage of 24 Volts and a Voltage Drop Allowance of 3% through the wire

Wattage [W]	Maximum Wire Length From Power Supply to Start of Run [ft]						
	12 AWG	14 AWG	16 AWG	18 AWG	20 AWG	22 AWG	24 AWG
5	1088.2	684.4	430.3	270.6	170.2	107.1	67.3
10	544.1	342.2	215.1	135.3	85.1	53.5	33.7
15	362.7	228.1	143.4	90.2	56.7	35.7	22.4
20	272.0	171.1	107.6	67.7	42.6	26.8	16.8
25	217.6	136.9	86.1	54.1	34.0	21.4	13.5
30	181.4	114.1	71.7	45.1	28.4	17.8	11.2
35	155.5	97.8	61.5	38.7	24.3	15.3	9.6
40	136.0	85.5	53.8	33.8	21.3	13.4	8.4
45	120.9	76.0	47.8	30.1	18.9	11.9	7.5
50	108.8	68.4	43.0	27.1	17.0	10.7	6.7
55	98.9	62.2	39.1	24.6	15.5	9.7	6.1
60	90.7	57.0	35.9	22.6	14.2	8.9	5.6
65	83.7	52.6	33.1	20.8	13.1	8.2	5.2
70	77.7	48.9	30.7	19.3	12.2	7.6	4.8
75	72.5	45.6	28.7	18.0	11.3	7.1	4.5
80	68.0	42.8	26.9	16.9	10.6	6.7	4.2
85	64.0	40.3	25.3	15.9	10.0	6.3	4.0
90	60.5	38.0	23.9	15.0	9.5	5.9	3.7
96	56.7	35.6	22.4	14.1	8.9	5.6	3.5

## Power Supplies

See Power Supply instructions and spec sheet for wiring information. For a complete list of compatible dimmers, see Compatible Dimming Chart on the Resources page.

### Triac, MLV, ELV Compatible Dimmers

MODEL	POWER	OUTPUT
PDC - (IP20) Power Supply	96 - 96 Watts	24 - 24 VDC

MODELS	96W
Length	8.25"
Width	4.10"
Depth	1.56"

