

ARTEMIS 3

RECESSED LED DOWNLIGHT



Artemis 3 - Recessed LED Downlight. Artemis 3 features SENSO-designed reflectors and a wide range of color temperatures in a high performance yet efficient and compact package. As part of the Artemis family of downlights, it's easy to get a cohesive design regardless of fixture size or style.

Ordering Code

Fixture	AR3D								
	1	2	3	4	5	6	7	8	9
Driver		AR3D	--			--	--	--	
	1	2	3	4	5	6	7	8	

Product Specifications

SAMPLE: Fixture **AR3D - TL - A90 - 610 - 25 - 10 - DL - 02 - 08** | Driver **910 - AR3D - TL - STD - 120 - A90 - 07 - 08**

1 - Model	2 - Trim	3 - LED	4 - Optic	5 - CCT	6 - Lumen	7 - Accessory	
AR3D · Artemis 3 Downlight	FL · Flanged TL · Trimless	A90 · 93+ CRI Accuracy	<i>Faceted</i> 610 · 10° 618 · 18° 630 · 30° 645 · 45° 660 · 60°	<i>Smooth</i> 630S · 30° 645S · 45° 680 · 80°	25 · 2500K 27 · 2700K 30 · 3000K 35 · 3500K 40 · 4000K 65 · 6500K	10 · 1000 (9.1W) 15 · 1500 (14W) 20 · 2000 (19.8W) 30 · 3000 (31.8W)	00 · No Accessory DL · Diffusing Lens HO · Honeycomb

8 - Trim Color	9 - Baffle Color	1 - Housing Style	2 - Model	3 - Trim	4 - Driver	Dim Level
01 · White 02 · Black 08 · Silver XX · Custom	01 · White 02 · Black 08 · Silver XX · Custom	910 · Remote 915 · New Construction 920 · IC Housing ^{*1/7} 930 · Chicago Plenum ^{*1/7}	Same as Fixture	Same as Fixture	STD · Non Dimming LCS · 0 - 10 Volt Protocol DIM · Phase ^{*2/3} ELDOLC · EldoLED 0 - 10 Volt DALI · Dali Protocol LUTES · HiLume Ecodigital LUT2W · 2 Wire for phase ^{*3} DMX · SENSO ^{*4} EMG · Emergency Driver ^{*4/5} CSMB · Casambi Wireless Control ^{*4/5}	N/A 1% 10% 0.1% 0.1% 1% 1%

5 - Voltage	6 - LED	7 - Lumen	8 - Baffle Color ^{*6}	Footnotes		Project : _____
120 · 120V 277 · 277V 347 · 347V	Same as Fixture	Same as Fixture	Same as Fixture	*1 Cannot exceed 1500lm	*2 Not available in 3000lm	Quantity : _____
				*3 Not available in 277V	*4 Remote mounted	Type : _____
				*5 Specified separately	*6 Only needed for Trimless	Notes : _____
				*7 JA8 Compliant		

ARTEMIS 3

RECESSED LED DOWNLIGHT

LED Module Performance

- Output:** up to 3000lm
- High Efficacy:** up to 101 lumen/Watt
- Color Options (CCT):** 2500K, 2700K, 3000K, 3500K, 4000K or 6500K
- Color Consistency:** Range within a 3-MacAdam Ellipse
- Color rendering (CRI):** 93+ CRI & R9 Value of 50+

Driver and Power Consumption

- Dimming:** 1% dimming standard with 0.1% option
- Ripple:** Industry leading Low ripple
- Efficiency:** Power Factor >0.9
Efficiency over 85%
Class 2 output for safety
- Installation:** Small Footprint allows retrofit installations

Lumen Option	1000lm	1500lm	2000lm	3000lm
Fixture Wattage	9.1W	14W	19.8W	31.8W
Delivered Lumen	913lm	1421lm	2001lm	2910lm

Accessories

Diffusing Lens

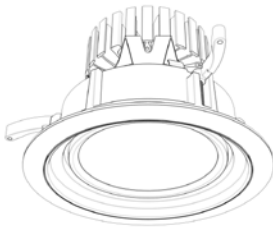

Honeycomb Mesh

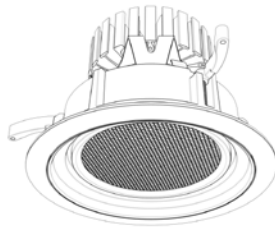

Installation

- For new and retrofit installations
- Simple connection between fixture and driver via quick connect

Construction / Finish

- Satin powder coated finish
- Custom finishes are available
- Cast Aluminum Trim
- Rated for damp locations
- Made in Canada

Dimensions

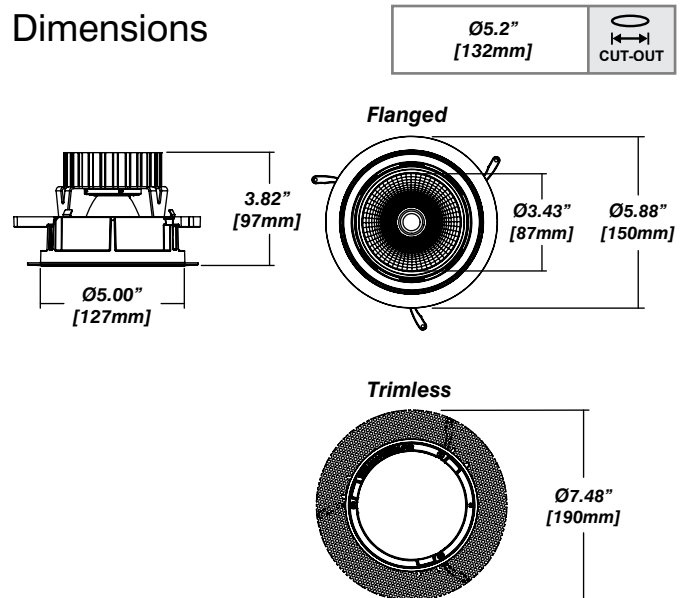

Reflector

Faceted Reflector

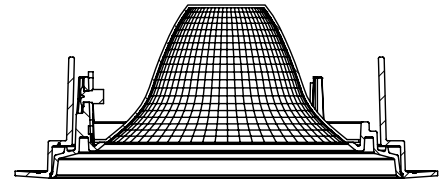

Smooth Anodized Reflector

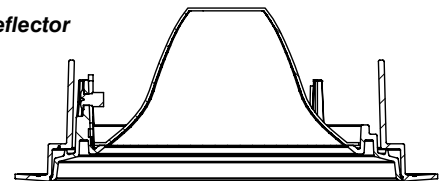

ARTEMIS 3

RECESSED LED DOWNLIGHT

Housing Options

Standard Senso Housing - 910

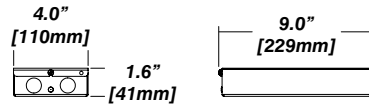
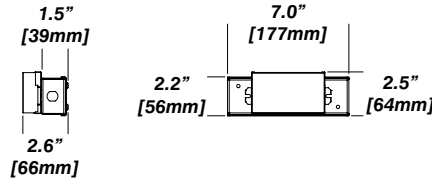
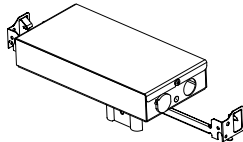
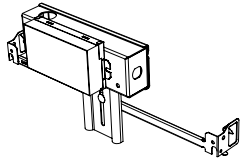

Dimension

Included

Unless specified otherwise, this is provided as standard

- Driver with enclosure**
- Galvanized steel enclosure
- Installation**
- Laying on top of ceiling
 - Remote from fixture
 - Hanger bar and mount included

New Construction - 915

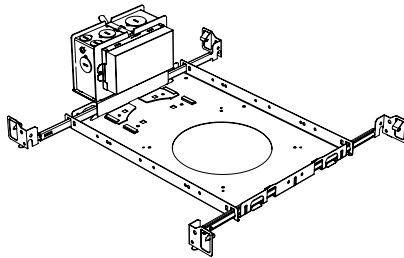

Dimension

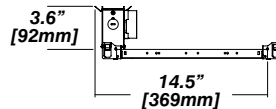
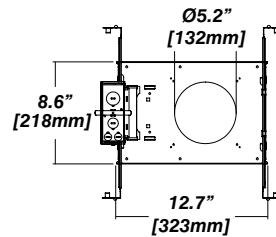

Included

- Plaster Frame**
- Galvanized steel construction with cut-out
- Bar hanger**
- Length: from 14-3/16" to 26"
- Outlet Box**
- Outlet Box Included

IC Housing - 920

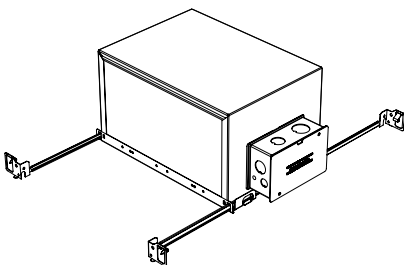

Dimension

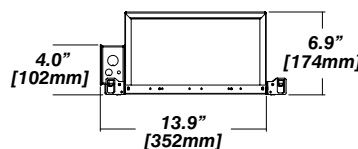
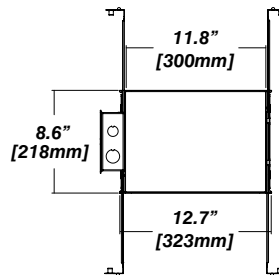

Included

- IC Housing**
- Galvanized steel construction
 - Airtight
 - Includes gasketed junction box
- Plaster Frame**
- Galvanized steel construction
- Bar hanger**
- Length: from 14-3/16" to 26"

Note: use only with LED modules up to 1500lm

